

RETIREMENT NOTICE

½ Inch (12.7mm) Microwave Conduit Fitting

Effective July 2024, Southwest Microwave **Model 316**, **Model 334** and **Model 336** Digital Microwave Intrusion Links (including Hi-Rel models) will no longer be supplied with a ½ in. (12.7mm) conduit fitting. Instead, these models will be supplied with a ¾ in. (19.3mm) conduit fitting.

For sites replacing a Southwest Microwave analog or digital link or transceiver that uses a ½ in. (12.7mm) conduit fitting, where infrastructure cannot be modified to accommodate a ¾ in. (19.3mm) fitting, an adapter kit is available to convert the ¾ in. (19.3mm) fitting to a ½ in. (12.7mm) fitting.

0247573-A01 Adapter Kit: ¾ to ½ in. (19.3 to 1.7mm) Conduit Fitting includes three (3) parts, as shown in Figure 1.

- A) 2647563-A01 Bushing, Reducer Adapter, NPT, SS
- B) 2946718-A01 Washer, Sealing, Gasket, SS Retainer
- C) 2945547-A03 Washer, Nylon Conduit, CRP

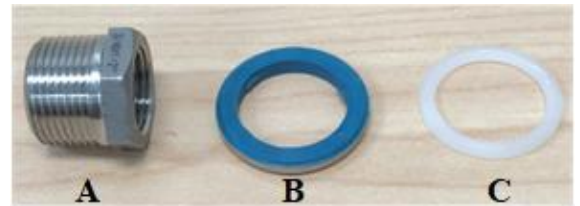

Figure 1

To install the Adapter Kit, remove the ¾ in. (19.3mm) conduit fitting from Model 316, 334 or 336 microwave link by unscrewing the nut on the conduit fitting, located on the interior side of the baseplate. Keep the nut, which will be reused with the new ½ in. (12.7mm) reducer adapter bushing. Feed the nylon washer then the sealing washer (thick part toward the baseplate) onto the threaded side of the ¾ in. (19.3mm) bushing. Reinsert the bushing through the baseplate and tighten with the nut. Screw the existing ½ in. (12.7mm) conduit fitting into the ¾ in. (19.3mm) bushing as shown in Figure 2.

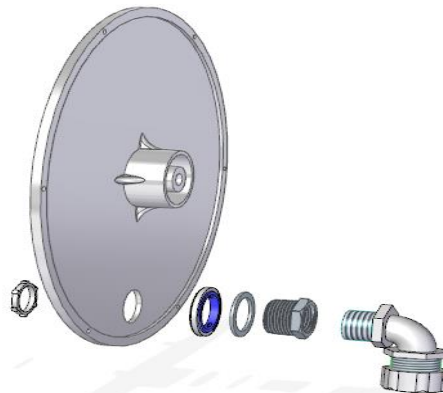

Figure 2